

# CHIPPING HAMMER RETAINERS

## Oval Collar Retainer



9101 Fit the following tool manufacturers.

**CONTINENTAL POWER TOOLS** CH-2 thru 4, CH-2A thru 4A,  
CFH-2 thru 4, CFH-2A thru 4A  
**CHICAGO PNEUMATIC TOOLS** CP-9362, 9363, 9364  
**HARPER AIR TOOLS** 4176F thru 4179F, 4171D thru 4174D  
**JET EQUIPMENT TOOLS** JCO-IRV thru 4RV, FBCH-1 thru 4  
**KENT AIR TOOLS** KCB 2 thru 4, KJR 1 thru 4  
**SULLAIR TOOLS** MCH-2 thru 4

4101 Fit the following tool manufacturer.

**AMERICAN PNEUMATIC TOOLS** 550 Series, 650 Series

## Round Collar Retainer



9103 Fit the following tool manufacturers.

**CONTINENTAL POWER TOOLS** CH-2 thru 4, CH-2A thru 4A,  
CFH-2 thru 4, CFH-2A thru 4A  
**CHICAGO PNEUMATIC TOOLS** CP-9362, 9363, 9364  
**HARPER AIR TOOLS** 4176F thru 4179F, 4171D thru 4174D  
**JET EQUIPMENT TOOLS** JCO-IRV thru 4RV, FBCH-1 thru 4  
**KENT AIR TOOLS** KCB 2 thru 4, KJR 1 thru 4  
**SULLAIR TOOLS** MCH-2 thru 4

4103 Fit the following tool manufacturer.

**AMERICAN PNEUMATIC TOOLS** 550 Series, 650 Series

## Ball Bearing Retainer



9104 Fit the following tool manufacturers.

**CONTINENTAL POWER TOOLS** CH-2 thru 4, CH-2A thru 4A,  
CFH-2 thru 4, CFH-2A thru 4A  
**CHICAGO PNEUMATIC TOOLS** CP-9362, 9363, 9364  
**HARPER AIR TOOLS** 4176F thru 4179F,  
4171D thru 4174D  
**JET EQUIPMENT TOOLS** JCO-IRV thru 4RV,  
FBCH-1 thru 4  
**KENT AIR TOOLS** KCB 2 thru 4, KJR 1 thru 4  
**SULLAIR TOOLS** MCH-2 thru 4

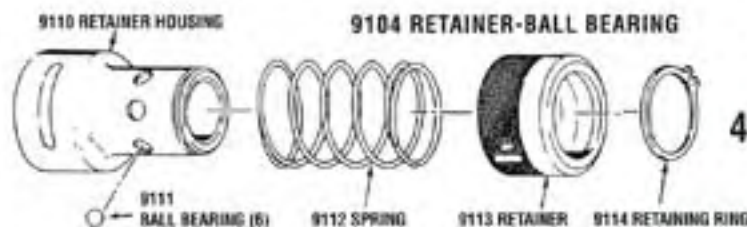

4104 Fit the following tool manufacturer.

**AMERICAN PNEUMATIC TOOLS** 550 Series, 650 Series

## Wide Blade Retainer



9106 Fit the following tool manufacturers.

**CONTINENTAL POWER TOOLS** CH-2 thru 4, CH-2A thru 4A,  
CFH-2 thru 4, CFH-2A thru 4A  
**CHICAGO PNEUMATIC TOOLS** CP-9362, 9363, 9364  
**HARPER AIR TOOLS** 4176F thru 4179F, 4171D thru 4174D  
**JET EQUIPMENT TOOLS** JCO-IRV thru 4RV, FBCH-1 thru 4  
**KENT AIR TOOLS** KCB 2 thru 4, KJR 1 thru 4  
**SULLAIR TOOLS** MCH-2 thru 4

4106 Fit the following tool manufacturer.

**AMERICAN PNEUMATIC TOOLS** 550 Series, 650 Series